



23 Barham Mews, Teston, Maidstone, Kent, ME18 5BL

Price guide £160,000 - £169,950

Jack Charles
Estate Agents

Sales & Lettings

- Ground Floor Retirement Apartment
- Living Room
- Beautiful Gardens

- Two Bedrooms
- Kitchen
- Stunning Location

- Bathroom
- Car Port
- Viewings Recommended

FLOORPLAN: Dimensions are maximum unless stated – subject to copyright this plan is intended as a guide to layout only and must not be relied upon for any other purpose.

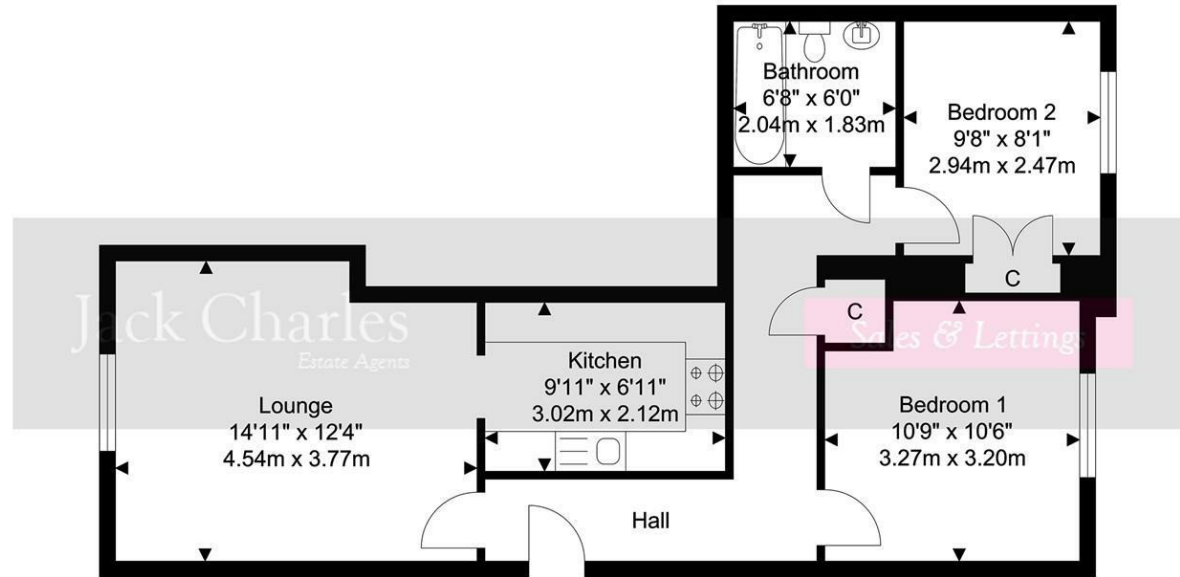

TOTAL APPROX FLOOR AREA 615.26 SQ.FT. (57.16 SQ. M.)
For Identification Purposes Only.



Important Notice:
These property details are intended to give a fair description and give guidance to prospective Purchasers/Tenants. They do not constitute an offer or contract of Sale/Tenancy and all measurements are approximate. While every care has been taken in the preparation of these details neither Jack Charles Property Services Ltd nor the Vendor/Landlord accept any liability for any statement contained herein. Jack Charles Property Services Ltd has not tested any services, appliances, equipment or facilities, and nothing in these details should be deemed to be a statement that they are in good working order or that the property is in good structural condition or otherwise. We advise all applicants to commission the appropriate investigations before Exchange of Contracts/entering into a Tenancy Agreement. It should not be assumed that any contents/furnishing, furniture etc. photographed are included in the Sale/Tenancy, nor that the property remains as displayed in the photographs. No person in the employment of Jack Charles Property Service Ltd has authority to make or give any representation or warranty whatever in relation to this property.

To Be Sold

Jack Charles are delighted to offer for sale this super two bedroom ground floor retirement apartment situated in Teston.

Set within a stunning development surrounded by countryside and beautifully maintained formal gardens with magnificent views over the Medway Valley. The accommodation comprises entrance hall, living room, kitchen, two bedrooms and bathroom. Outside is an allocated car port and ample spaces for visitors and stunning terraces and gardens and courtyard areas.

The property is within a retirement community with a live in manager. There is a nearby village shop, social club and church within walking distance. There is also the added benefit a local cricket club with a few hundred yards and community residents association. Viewings are recommended.

Teston

Situated just off the A26 the property is in a great location for weekend strolls and is surrounded by rolling countryside. The road offers links into Maidstone which is just 4.6 miles for easy access to all the great schools, high street shops, cafes, pubs, restaurants and eateries the county town has to offer. Wateringbury Train Station is just 1.5 miles down the road, plus Maidstone offers the three main stations; Maidstone East, West, and Barracks, for fast links into London. The local area has much to offer including a beautiful church across the road, Teston Bridge Country Park for recreation and river walks.



Energy Efficiency Rating		Current	Future
Very energy efficient - lower running costs			
(92 plus) A			
(81-91) B			
(69-80) C			
(55-68) D			
(39-54) E			
(21-38) F			
(1-20) G			
Not energy efficient - higher running costs			
England & Wales		EU Directive 2002/91/EC	





Jack Charles
Estate Agents

Sales & Lettings

Castle Lodge
Castle Street, Tonbridge
Kent, TN9 1BH
Tel: (01732) 75 75 80
E-mail: info@jackcharles.co.uk
www.jackcharles.co.uk

