



Dairy Cottage, Dry Hill Farm Shipbourne Road, Tonbridge, TN10

£1,800 Per month

Jack Charles are delighted to be appointed as agents for this superb detached Grade II listed property which has a wealth of character and is set within a private drive superbly located for both Tonbridge High Street and the station. Dairy Cottage originally dates back to the 16th Century and offers well proportioned accommodation arranged over two floors with two staircases which make us believe it was once two cottages. The reception hall leads into the sitting room with a brick inglenook open fireplace and a fitted bookcase. There is a staircase to the cellar, and another to the first floor. The kitchen/dining room provides a spacious area ideal for both everyday and formal dining. Double doors lead into the rear lobby with a staircase rising to the master bedroom, and access to the rear. The adjoining utility room includes additional base cupboards with work surfaces incorporating a sink, space for washing machine, dishwasher, fridge and freezer. The bathroom comprises a fitted bath with shower attachment, wash basin and W.C. and completes the ground floor accommodation. To the first floor generously proportioned master bedroom accessed from one staircase and two further double bedrooms accessed from the staircase in the sitting room. Outside the property provides parking for one car and there is a private enclosed courtyard garden. Viewings Recommended. Available In August

- Grade II Listed Cottage
- Detached
- Central Location
- Three Bedrooms
- Kitchen / Dining Room
- Bathroom
- Cellar
- Sitting Room
- Courtyard Garden & Parking
- Available In August

Viewing

Please contact our Jack Charles Tonbridge Office on 01732 75 75 80 if you wish to arrange a viewing appointment for this property or require further information.



3



1



3



Floor Plan

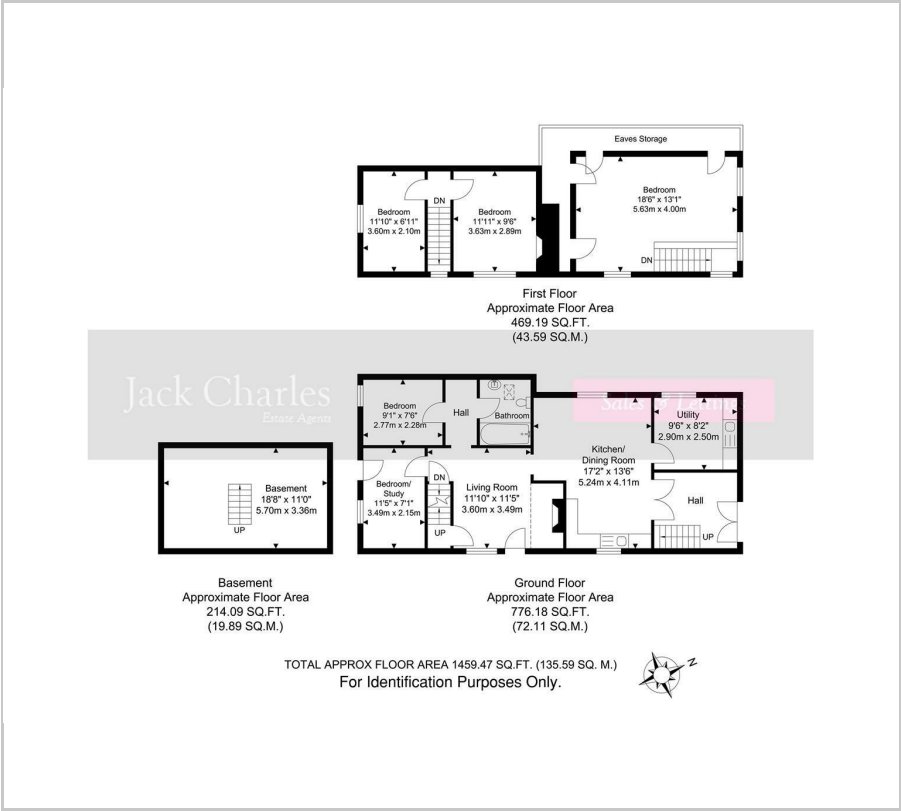

Area Map



Energy Efficiency Graph



These particulars, whilst believed to be accurate are set out as a general outline only for guidance and do not constitute any part of an offer or contract. Intending purchasers should not rely on them as statements of representation of fact, but must satisfy themselves by inspection or otherwise as to their accuracy. No person in this firms employment has the authority to make or give any representation or warranty in respect of the property.